

**SUPPLEMENTAL / BID BULLETIN**

**ADDENDUM NO. 19-13**

**“2nd Bidding – Design, Supply and Installation of Office Furniture in the New MCWD Office Building (PR#19-09-1006)”**

This Addendum No. 19-13 dated December 10, 2019 is issued to clarify, modify or amend items in the Bidding Documents, which shall form an integral part thereof:

<b>ISSUES</b>	<b>CLARIFICATIONS / AMENDMENTS</b>
<p><b>Section VII. Technical Specifications (page 55)</b></p> <p>Prepare architectural / interior design/plans, Program of Works and Program Evaluation Review Technique (PERT)/Critical Path Method (CPM) (with corresponding costs) that suits the existing structure considering the following feature of the new building.</p> <p><b>Delivery Schedule: page 57</b></p> <p>ii. Program Evaluation Review Technique (PERT)/Critical Path Method (CPM)</p> <p><b>Colors of the Furniture: Page 59</b></p> <p>Must submit two (2) different color combinations of the furniture design; Colors are subject for approval of MCWD Project-in-charge unless stated in the technical specifications.</p> <p><b>Senior Executive Table for GM (1 Unit) – Page 60</b></p> <p><b>TABLE TOP:</b></p> <ul style="list-style-type: none"> <li>Industrial grade, High density particle board with High Pressure Laminate (HPL) finish similar to Formica with <b>0.8mm</b> thickness</li> </ul> <p><b>SIDE RETURN TABLE :</b></p> <ul style="list-style-type: none"> <li>1.00 m x 0.45m HPL post form table top with metal modesty panel in powder coat finish (to include antirust treatment). 2.2 inches square pip metal legs with anti-rust and powder coat finish</li> </ul> <p>Drawer lock with key shall be provided</p>	<p><b>Section VII. Technical Specifications (page 55)</b></p> <p>Prepare architectural / interior design/plans, Program of Work and GANTT Chart (with corresponding costs) that suits the existing structure considering the following feature of the new building.</p> <p><b>Delivery Schedule: page 57</b></p> <p>ii. Program of Work and GANTT Chart</p> <p><b>Colors of the Furniture: Page 58</b></p> <p>Colors are subject for approval of MCWD Project-in-charge unless stated in the technical specifications.</p> <p><b>Senior Executive Table for GM (1 Unit) - Page 60</b></p> <p><b>TABLE TOP:</b></p> <ul style="list-style-type: none"> <li>All Formica with <b>2mm</b> thickness</li> </ul> <p><b>FIXED SIDE RETURN TABLE :</b></p> <ul style="list-style-type: none"> <li>1.00 m x 0.45m HP Laminated finish with built-in cabinet and wooden 3 drawers mobile pedestal</li> </ul> <p>All drawer lock with key – deleted</p>

**Senior Executive Table for Department Managers (3 units) – Page 61**

**SIDE RETURN TABLE :**

- 0.90 m x 0.45m HPL post form table top with metal modesty panel in powder coat finish (to include antirust treatment). 2.2 inches square pip metal legs with anti-rust and powder coat finish

**Executive Tables for Division Managers (8 Units) – Page 62**

**SIDE RETURN TABLE:**

- 0.80m HPL post form table top with metal modesty panel in powder coat finish (to include antirust treatment). 2.2 inches square pip metal legs with anti-rust and powder coat finish

**Cubicle Workstation with Mobile Pedestals**

- Upper portion with laminated glass partitions (Submit color for approval)
- Inside of partition contains High-quality Honeycomb Board that provides sturdiness and minimizes loud sound.
- Supplier is required to present mock-up unit or show actual installation of similar specifications.

**Senior Executive Chair for GM – (1 Unit) – Page 80**

- German leather upholstery
- Adjustable lumbar support
- Color as seen on Picture, must be appropriate with the Executive GM Table.
- ANSI BIFMA 5.1 Test Report

**Executive Chair (High Back with Head Rest) for Division Managers/BAC Conference Room (20 Units) – Page 82 & 84**

- With Armrest and Head Rest
- Heavy Duty Mesh Finish

**Executive Chairs for Office and COA Staffs (70 Units) – Page 85**

- Heavy Duty Mesh Finish
- Adjustable lumbar support

**Visitors Chair for GM (2 Units) – Page 85**

- Sled Type Metal Chrome Base
- Heavy Duty Mesh Finish

**Senior Executive Table for Department Managers (3 units) – Page 61**

**FIXED SIDE RETURN TABLE :**

- 0.90 m x 0.45m HP Laminated finish with built-in cabinet and wooden 3 drawers mobile pedestal

**Executive Tables for Division Managers (8 Units) – Page 62**

**FIXED SIDE RETURN TABLE :**

- 0.80m x 0.45m HP Laminated finish with built-in cabinet and wooden 3 drawers mobile pedestal

**Cubicle Workstation with Mobile Pedestals**

- Upper portion with 0.15m HPL and 0.30m glass partitions (Submit color for approval) in all cubicle workstation
- Deleted
- Site inspection shall be conducted by TWG in the completed project of winning bidder

**Senior Executive Chair for GM – (1 Unit)**

**All Chair Dimension – Based on Chair Starbase**

- All German leather upholstery for Chairs - Deleted
- Deleted
- Color must be appropriate with the Executive table of the GM.
- All Chairs - ANSI BIFMA 5.1 Test Report (to be submitted by the winning bidder only)

**Executive Chair (High Back with Head Rest) for Division Managers/BAC Conference Room (20 Units) – Page 80 & 78**

- With adjustable Armrest and Head Rest
- Heavy Duty Mesh Finish on backrest and headrest
- Leatherette upholstery on seat pad

**Photo similar to Executive Chair of the Division Managers**

**Executive Chairs for Office and COA Staffs (70 Units) – Page 81**

- Heavy Duty Mesh Finish at back rest
- Fixed lumbar support
- Fabric seat pad

**Visitors Chair for GM (2 Units) – Page 81**

- Sled Type Powder Coated Black Base
- Leatherette finish

**Visitors Chair for Departments Managers (6 Units) – Page 86**

- Heavy Duty Mesh Finish
- With padded arms

**Visitors Chair for Division Managers (16 Units) – Page 86**

- Sled Type Metal Chrome Base

**Executive Wall Cabinet for GM Conference Room (1 Unit) – Page 87**

**Cabinet for Department Managers (6 Units) – Page 87**

**Lateral Filing Cabinet (10 Units) – Page 88**

- Anti-rust treatment to be applied prior to final finish. Final finish shall be high gloss powder coat finish that is scratch resistant
- Levelling glides, provided at all four corners to provide stability
- 20mm adjustable foot caps from side

**Gang Chair: Page 89**

- Grey Color

**Pantry Tables and Chair Set: Page 91**

- 6 Units Table

**Visitors Chair for Departments Managers (6 Units) – Page 82**

- Leatherette finish
- Deleted
- Color must match with Department Managers Chair

**Visitors Chair for Division Managers (16 Units) – Page 82**

- Deleted
- Color must match with Division Managers Chair

**Executive Wall Cabinet for GM Conference Room (1 Unit) – Page 83**

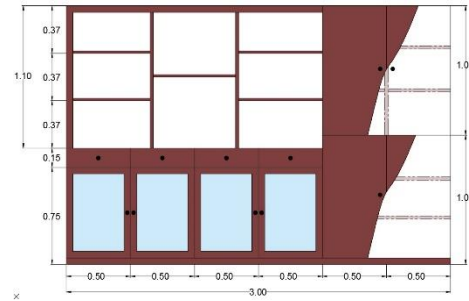

**Cabinet for Department Managers (6 Units) – Page 85**



**Lateral Filing Cabinet (10 Units) – Page 85**

- Deleted
- Deleted
- Deleted
- All Filing Cabinet is Powder coat finish
- All Filing Cabinet Thickness is gauge 22mm

**All Gang Chairs: Page 87**

- Silver Color

**Pantry Tables and Chair Set: Page 93**

- 4 Units Table

<p><b>Built-in Cabinet (Top &amp; Bottom) - (4 lots)</b></p> <ul style="list-style-type: none"> <li>• High Quality Waterproof MDF material, Cabinets shall be kitchen cabinet with drawers and swing doors soft close, hinges and shelves.</li> </ul> <p><b>Bid Form: Annex A 1</b></p> <ul style="list-style-type: none"> <li>• Executive Chair for Staffs &amp; COA – 70 Units</li> <li>• Visitor Chair for Staff &amp; COA – 36 Units</li> <li>• Interior Design for Board Room including the supply of complete furnitures</li> <li>• Built-in Top &amp; Bottom Cabinet, Walls, Ceilings 42.8 sq. m. (Please indicate costing of each item)</li> <li>• Interior Design for BOD Chairman’s Office including the supply of complete furnitures</li> <li>• Center Table, Walls, Ceilings</li> <li>• 31 sq.m.</li> </ul>	<p><b>Built-in Cabinet for Pantries (Top &amp; Bottom) - (4 lots)</b></p> <ul style="list-style-type: none"> <li>• Marine plywood HPL 18mm laminated cabinets. Design shall be kitchen cabinet with drawers and swing doors soft close, hinges and shelves.</li> <li>• All material for pantry cabinets shall be Marine plywood HPL 18mm</li> </ul> <p><b>Bid Form: Annex A 1</b></p> <ul style="list-style-type: none"> <li>• Executive Chair for Office &amp; COA Staffs – 70 Units</li> <li>• Visitor Chair for Office &amp; COA Staffs – 36 Units</li> <li>• Interior Design for Board Room including the supply of complete furniture (42.8 sq.m.)</li> <li>• 1 unit - Built-in Top &amp; Bottom Cabinet for Pantry <i>(Please indicate costing of each item)</i></li> <li>• Interior Design for BOD Chairman’s Office including the supply of complete furniture (31 sq.m)</li> <li>• Center Table</li> <li>• Deleted</li> </ul>
--	--

For guidance and information of all concerned.

Signed  
**WINSTON L. SAPAL**  
 BAC Chairperson

Received by the Bidder: \_\_\_\_\_  
 Date: \_\_\_\_\_